

IRON ROCK OFF ROAD

JK Engine/Trans Skid
Instructions

1-877-919-JEEP www.ironrockoffroad.com

See our website product listing for full color instructions

Parts Checklist:

- Iron Rock Off Road Logo Decal (1)
- Ironrockoffroad.com decal (1)
- Skid Plate 80185 (1)
- Skid Plate Access Panel 80126 (1)
- Skid Plate Spacer 80190 (1)
- Support Arm, Driver 80199 (1)
- Support Arm, Passenger 80201 (1)
- #265 – Engine Skid Hardware (1)**
 - M12-1.75 x 80 hex bolt class 10.9 (1)
 - M12-1.75 nylock hex nut (1)
 - 3/8" USS washer (2)
 - M10-1.5 x 30 hex bolt class 10.9 (2)
 - M10-1.5 nylock flange nut (2)
 - 1/2"-13 x 1-1/2" hex bolt, gr8 (2)
 - 7/16" USS washer (4)
 - 1/2"-13 nylock nuts (2)
 - 5/16"-18 x 1" Taptite flange bolt (1)
 - 5/16"-18 x 3/4" Button head bolt (1)

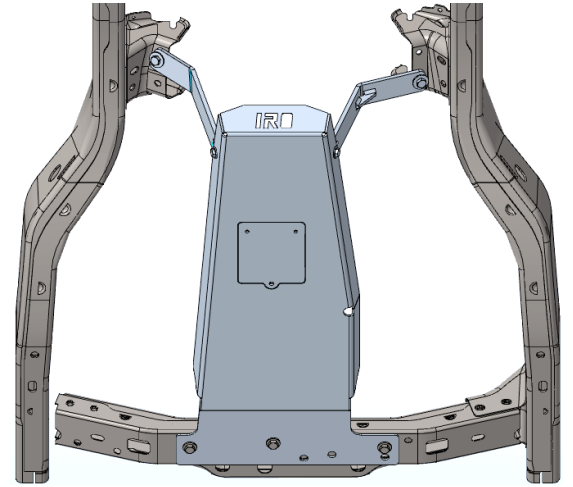

Safety Warning: *****Important! Read before installation.*****

We recommend this system be installed by a qualified professional. Knowledge of component function is necessary for safe installation and post installation inspections. Be sure to re-torque all components after the first 100 miles of use, and frequently inspect all safety critical components.

Before you begin:

- ***Ensure that all parts are present and in good condition using above shipping checklist.***
- Read and understand all installation instructions.
- Tools required:
 - Floor jack and jack stands
 - Basic hand tools
 - Torque wrench

5/16 Bolts
Thread-Forming & Button Head



Prepare the parts for installation:

1. Using the provided 5/16 thread forming hex bolt, thread the bolt hole for the skid plate access panel. *An extra 5/16 button head bolt is provided if you prefer a lower-profile fastener.

Installation:

2. Lift front of vehicle and support with jack stands under frame rails.
3. Allow the front axle to droop away from the chassis as much as possible to make install easier.
4. Remove the "T" brace from under the engine and save the bolts for reuse.
5. Remove the bolts from the transmission crossmember that hold the t-case skid plate.

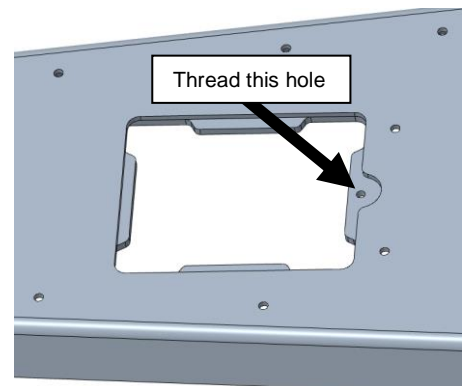
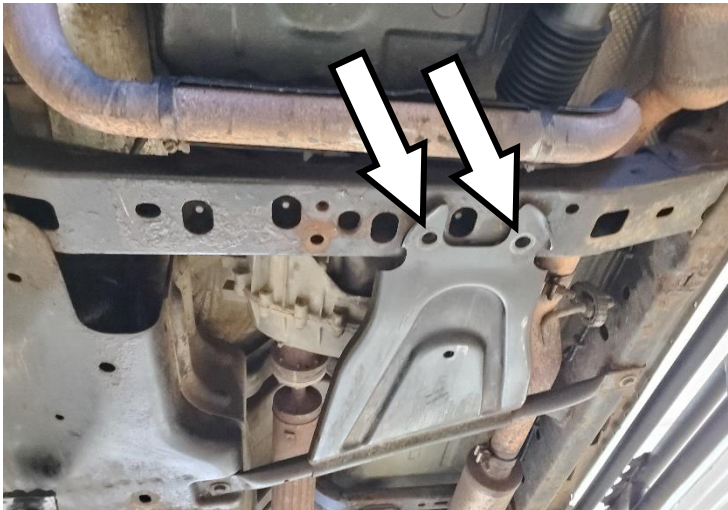

6. Locate the skid plate support arms and **HK #265**.
7. Install the driver side support arm into the rear-most hole on the engine mount bracket on the frame. Use a 1/2" bolt, washer and nut. Do not tighten the hardware at this time.

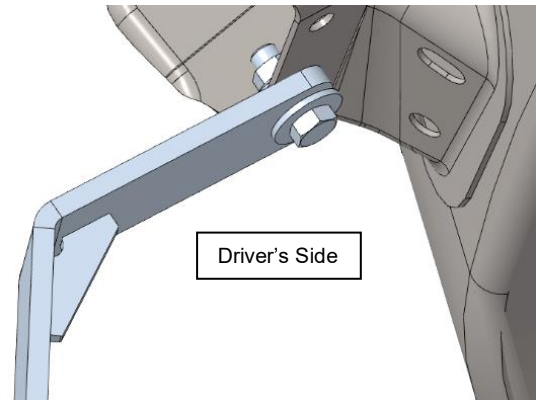
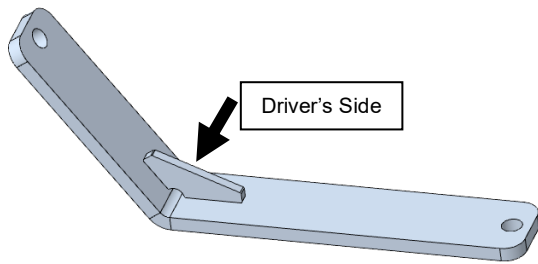

8. Install the passenger's side support arm into the forward-most hole on the engine mount bracket on the frame. Use a 1/2" bolt, washer and nut. Do not tighten the hardware at this time.

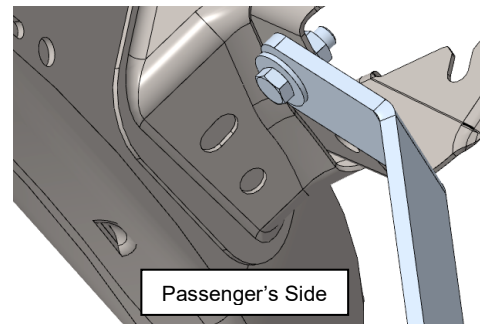
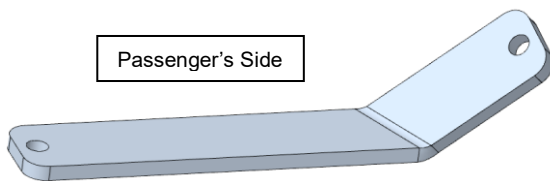

9. Install the engine skid plate using the original t-case skid bolts at the crossmember and M10 bolts, washers, and nylock nuts at the support arms.
The support arms go on the **outside** of the skid plate
10. **3.8L Only:** Install the spacer plate between the skid plate and the transmission crossmember to provide room for the exhaust.
*Do not tighten bolts until all hardware is installed.
11. Use the M12 x 80 bolt, nut and washers in the skid plate hole closest to the gas tank.

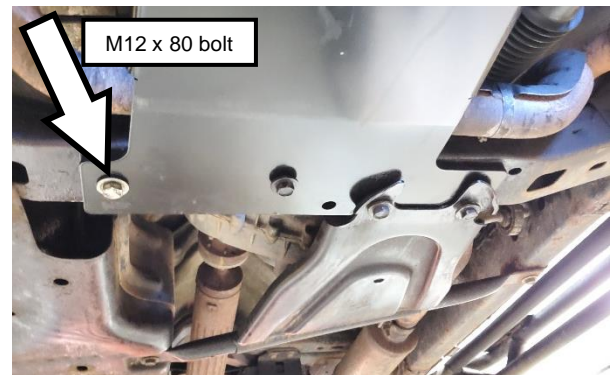

12. With all the bolts installed, tighten the 1/2" and M12 bolts to 60lb-ft, M10 to 45lb-ft.
13. Install the access panel in the skid plate by inserting the tabs up, into the opening then hinging the panel up to the skid plate.
14. Secure the access panel with a 5/16 x 3/4" serrated flange bolt.
15. Double check all hardware then lower the Jeep to the ground.

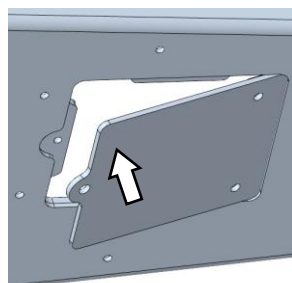
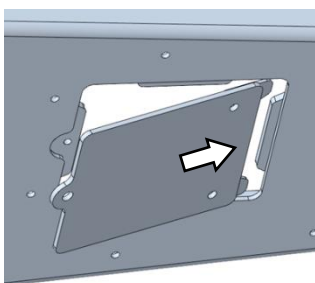

Final Safety Warning:

16. *Re-torque all fasteners after 100 miles, and frequently inspect all safety critical components. It is the responsibility of the installer to be sure all fasteners are properly tightened after installation and to ensure the owner knows his/her ongoing responsibility. It is the responsibility of the owner of the vehicle to be sure all safety critical components are inspected frequently, especially after off road or other demanding use.