

IRON ROCK OFF ROAD

WJ A-Arm IRO Flex End Assembly Instructions

I-877-919-JEEP www.ironrockoffroad.com

Fitment:

Fits All Iron Rock Off Road WJ A-Arms.
Does not fit OEM or other brand A-Arms.

Parts Checklist:

#176 –WJ A-Arm Flex End Hardware (1)

- Top End Cap 91158 (1)
- Bottom End Cap 91159 (1)
- Race 91160 (2)
- Ball 91161 (1)
- 10-32 x 1-1/2" Socket Head Cap Screw (6)
- 90 Degree 1/4"-28 Grease Zerk Fitting (1)

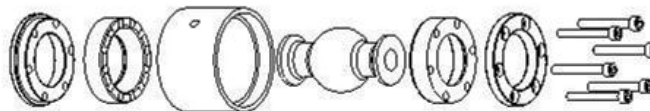

Before you begin:

- o Read and understand installation instructions.
- o Contact Iron Rock Off Road with any questions before, during, or after installation.
- o **Ensure that all parts are present and in good condition per attached shipping checklist!**
- o Have these tools handy:
 - o 5/32 allen head socket
 - o Inch-lb. torque wrench
 - o #3 (.2130) drill bit
 - o 1/4-28 Hand tap

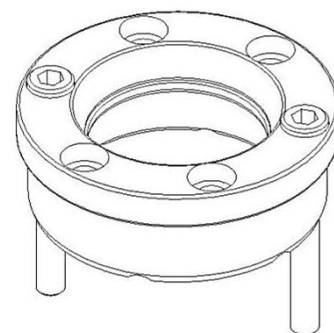

Assembly:

1. Remove existing rubber bushing including the outer sleeve.
 - a) Remove built in washer using a pry bar.
 - b) Use either a drill bit, sawzall, or torch to remove the rubber portion of the bushing and the center sleeve.
 - c) Slice the outer sleeve of the rubber bushing with a sawzall and remove from a-arm.
2. Drill and tap the bushing tube as shown with the 1/4-28 tap for the grease zerk.
3. Insert two 10-32 socket head cap screws into unthreaded end cap and one plastic race. Spherical bore of race facing away from end cap.
4. Install this small assembly into the flex end housing. The races are a light press fit, use a wide punch and hammer to assist you if needed.
5. Apply a thin coating of multi-purpose grease to the mating surfaces of the ball and both races.
6. Place the ball in the race (inside the flex end). The ball should perfectly fit the contour of the race.
7. Insert the other race onto the ball so that the spherical bore is contacting the ball. Once again, the races are a light press fit, use a hammer and wide punch if needed.
8. Insert the second end cap on top of the flex end housing, threading the bolts into the holes.
9. Insert the remaining four cap screws through the remaining holes and thread into the end cap.
10. Snug up all of the bolts fairly tight.
11. Torque bolts evenly starting at one bolt using a crisscross pattern, like torquing lug nuts. Torque all six bolts to 70 in/lbs., then to 85 in/lbs.
12. Install 90 Degree grease zerk fitting so that it is easily accessed in the vehicle.
13. Grease flex end until grease comes out of the races around the ball.
14. Re-torque bolts to 85 in-lbs. after 5 minutes.

